



Campus Map & Directions

One Plainsboro Road, Plainsboro, NJ 08536 | 609.853.7000 | www.princetonhcs.org

Penn Medicine Princeton Medical Center is located on the east (northbound) side of Route 1, between Plainsboro Road and Scudders Mill Road in Plainsboro.

FROM THE SOUTH

Take Route 1 North to the Plainsboro Road exit. Make a right at the end of the exit onto Plainsboro Road and take the jughandle to make a left at the traffic signal onto Punia Boulevard, which is part of the hospital campus.

FROM THE NORTH

Take Route 1 South to the Scudders Mill Road exit. Take the overpass over Route 1 onto Scudders Mill Road. Make a right at the traffic signal onto Campus Road, then right onto Hospital Drive on the hospital campus.

FROM THE WEST

Take any one of several access roads to Route 1 and follow Route 1 directions above.

If you are taking one of the following roads, you will take Route 1 North: 1-95, Province Line Road, Alexander Road, Washington Road and Harrison Street. NOTE: Harrison Street has been significantly improved with the addition of a left-turning lane; it is now possible to turn left onto Route 1 from two lanes at Harrison Street.

If you are taking one of the following roads, use the directions from Route 1 South: College Road, Promenade Boulevard, Ridge Road and Raymond Road.

FROM THE EAST

From West Windsor/East Windsor:

Take Mercer County Route 571/Princeton-Hightstown Road. Make a right on Clarksville Road. Follow Clarksville Road to Cranbury Road. Make an immediate right onto Millstone Road. Millstone Road becomes Grovers Mill Road. Take Grovers Mill Road to Maple Avenue and make a left. Follow Maple Avenue to Plainsboro Road and make a left*. Continue toward the left to stay on Plainsboro Road. The entrance to the hospital is about a half-mile down on the right.

From East Windsor, Cranbury:

Take Old Trenton Road East and make a left on South Main Street in Cranbury. Follow to Plainsboro Road and make a left. Plainsboro Road merges with Middlesex County Road 614, which then becomes Scudders Mill Road. Take Scudders Mill Road to Campus Road and make a left. Make a right onto Hospital Drive into the hospital campus.

From Monroe/Jamesburg:

Take Route 130 to Middlesex County Road 614 (Dey Road). Make a gentle right onto Scudders Mill Road. Take Scudders Mill Road to Campus Road and make a left. Make a right turn onto Hospital Drive into the hospital campus.

From South Brunswick:

Take Ridge Road West to Middlesex County Road 683/Schalks Crossing Road. Take Schalks Crossing Road to Scudders Mill Road and make a right. Make a left onto Campus Road and then a right turn onto Hospital Drive into the hospital campus.

ALTERNATE ROUTES FROM THE WEST (EXCLUDING ROUTE 1)

FROM MONTGOMERY/ROCKY HILL/HILLSBOROUGH AREAS:

Take Somerset County Route 518 through Rocky Hill to River Road to Route 27 in Princeton Township. Make a left onto Route 27. Take Route 27 to Academy Street and make a right onto Academy Street, bearing right onto Mapleton Road. Take Mapleton Road to College Road and make a left. Take College Road through Forrester Center and over Route 1 to Scudders Mill Road. Make a right onto Scudders Mill Road and then a left at the traffic light onto Campus Road. Make a right into the hospital campus.

FROM LAWRENCE AND HOPEWELL:

Take Province Line Road, crossing over Route 1 to Quaker Bridge Road. Make a left onto Clarksville Road. Cross over Mercer County Route 571/ Princeton-Hightstown Road. Make a left onto Cranbury Road. Make an immediate right onto Millstone Road. Millstone Road becomes Grovers Mill Road. Take Grovers Mill Road to Maple Avenue and make a left. Follow Maple Avenue to Plainsboro Road and make a left*. Continue toward the left to stay on Plainsboro Road. The entrance to the hospital is about a half-mile down on the right.

** Please note: Left turns are prohibited at the intersection of Maple Avenue and Plainsboro Road between the hours of 7-9 a.m. and 4:30-6:30 p.m. An alternate route during these hours would be to make the turn from Grovers Mill onto Maple Avenue; rather than taking Maple all the way to the end at Plainsboro Road, make a right onto Edgemere Avenue. Make a left onto Parkway Avenue and another left onto Plainsboro Road.*

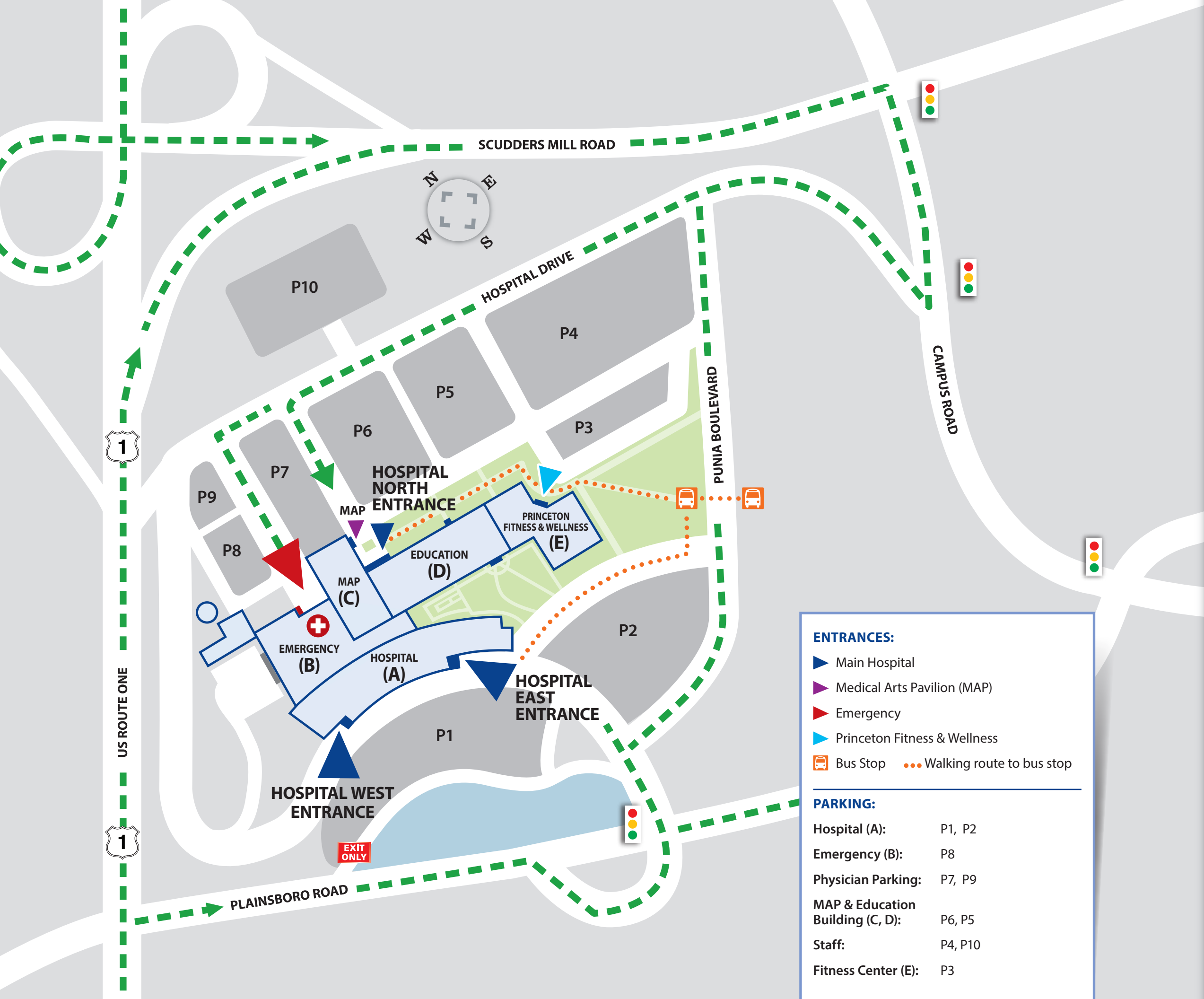

- A Atkinson Pavilion/Hospital:**
- Acute Care for the Elderly (ACE)
 - Acute Rehabilitation Unit
 - Princeton Center for Eating Disorders
 - Center for Maternal & Newborn Care:
 - Labor & Delivery
 - Neonatal Intensive Care Unit
 - Mother-Baby Unit
 - Center for Neuroscience Care
 - Institute for Surgical Care:
 - Peri-Operative Unit
 - Post-Anesthesia Care Unit (Recovery)
 - Pre-Admission Testing
 - Surgical Care Unit
 - Center for Testing & Treatment
 - Dialysis
 - Edward & Marie Matthews Center for Cancer Care
 - George & Estelle Sands Center for Cardiac & Pulmonary Care
 - Llura & Gordon Gund Center for Critical Care
 - Medical/Neurology/Oncology Unit
 - Regan Family Center for Pediatric Care
 - PMC-CHOP: Partners in Pediatric Care
 - Telemetry Unit

- B Center for Emergency Care (Emergency Department)**
- Imaging
 - Interventional Suite/Operating Rooms
 - Security

- C Medical Arts Pavilion (MAP):**
- Center for Bariatric Surgery & Metabolic Medicine
 - Center for Digestive Health
 - Department of Medicine
 - Department of Surgery
 - Maternal-Fetal Medicine
 - Diabetes Management Program
 - Occupational Health
 - Outpatient Imaging Center
 - Laboratory Services
 - Princeton Medical Center Foundation
 - Princeton Medicine Physicians
 - Private Physician Offices
 - Sleep Center
 - Stephen & Roxanne Distler Center for Ambulatory Surgery
 - Women's Imaging

- D Education Building:**
- Administration
 - Bristol-Myers Squibb Community Health Center
 - Center for Pelvic Wellness
 - Chapel of Light
 - Human Resources
 - Medical Staff Services
 - Medical Records
 - Schreyer Education Center
 - Volunteer Services

- E Princeton Fitness & Wellness**
- Krogh Outpatient Rehabilitation

ENTRANCES:

- ▶ Main Hospital
- ▶ Medical Arts Pavilion (MAP)
- ▶ Emergency
- ▶ Princeton Fitness & Wellness
- 🚌 Bus Stop ... Walking route to bus stop

PARKING:

Hospital (A):	P1, P2
Emergency (B):	P8
Physician Parking:	P7, P9
MAP & Education Building (C, D):	P6, P5
Staff:	P4, P10
Fitness Center (E):	P3



EXIT ONLY

